

DESK BLINDSTITCH MACHINE

桌上型盲縫機

MODELS **CM-500** (一般用 MID MATERIAL)

MODELS **CM-512** (薄物用 THIN MATERIAL)

❖ **INSTRUCTION MANUEL/PARTS LIST** ❖
使用說明書 / 零件冊

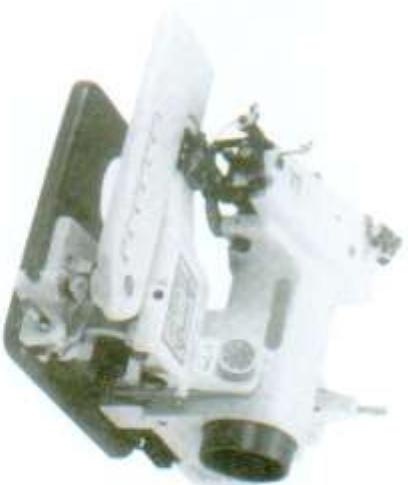

INSTRUCTION MANUEL

| 図号 Part No. | 零件号 Parts No. | 名称 Description | 単位 Unit |
|--|------------------|-----------------------------|------------|
| 1 | AC-02 | Screw Driver | 個/1 |
| 2 | AC-03 | Screw Driver | 個/1 |
| 3 | AC-101 | Sponner | 個/1 |
| 4 | AC-102 | Wrench(Span) | 個/1 |
| 5 | AC-06 | Wrench(Span) | 個/1 |
| 6 | C-1000 | Wrench(Span) | 個/1 |
| 7 | 4101 | Needle/WorT(Chev) | 個/1 |
| 8 | AC-09 | Turnover | 個/1 |
| 9 | AC-015A | Oil | 缶/2 |
| 10 | AC-015A | Oil | 缶/2 |
| 11 | 0110AA | Oil | 缶/2 |
| 12 | C-101A | Cushion Pad | 個/1 |
| 13 | 5-210P7 | Needle Clamp | 個/1 |
| 14 | 21101 | Master Clamp Assembly | 個/1 |
| 15 | 0021001 | Thread Guide | 個/1 |
| 16 | 21102 | Thread Guide Set Screw | 個/1 |
| 17 | 2-21006 | Thread Guide Stud | 個/1 |
| 18 | 2-21006 | Needle Press Pin & Sleeve | 個/1 |
| | 2-21008 | Needle Press Pin Assembly | 個/1 |
| (OPTIONAL PARTS for Needle system LW07T) | | | |
| 19 | 13026 | Needle Carrier | 個/1 |
| 20 | 13144 | Needle Carrier Clamp Screw | 個/1 |
| 21 | 13027 | Needle Clamp | 個/1 |
| 22 | 13149 | Needle Clamp Set Screw | 個/1 |
| 23 | 13028 | Needle (LW07T) | 個/1 |
| 24 | 13028 | Needle (LW07T) (P/N) | 個/1 |
| 25 | 21102 | Needle System Label (LW07T) | 個/1 |

索 引

| | |
|------------|----|
| 1. 機器的安裝 | 2 |
| A. 固定機器 | 2 |
| B. 安置綫座 | 2 |
| C. 連接馬達控制器 | 3 |
| D. 裝配腳弓 | 4 |
| 2. 潤滑 | 4 |
| 3. 針與綫 | 5 |
| 4. 換針 | 6 |
| 5. 上綫 | 6 |
| 6. 縫制的準備 | 8 |
| 7. 調整縫壓 | 9 |
| 8. 設定縫目 | 10 |
| 9. 調整下針深淺 | 10 |
| 10. 取出縫制物 | 11 |
| 11. 跳縫裝置 | 12 |

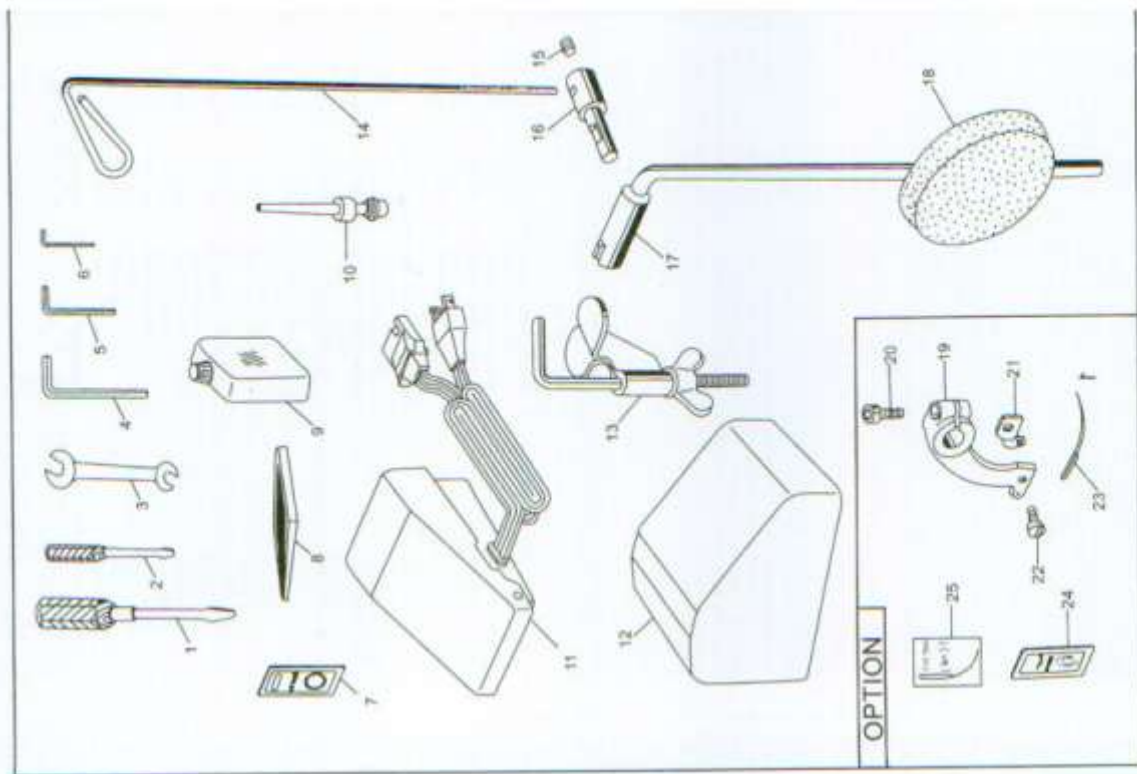

| 零件号 Part No. | 名称 Description | 材料 Material |
|-----------------|--|----------------|
| 4048 B | Plain Pressure Foot | 无材料 |
| 4185 | Cleaning Finger Set Screw | 镀锌钢六角螺栓 |
| 11060 | North Guide | 9-11 钢六角螺栓 |
| 11961A | South Scheduling Guide | 9-11 钢六角螺栓 |
| 4025A | North Guide Set Screw | 9-11 钢六角螺栓 |
| 4019 | Edge Guide | 9-11 钢六角螺栓 |
| 4185 | Edge Guide Set Screw | 无材料 |
| 4055 CAN | CAD Resener | 无材料 |
| 4185 | CAD Resener Screw | 无材料 |
| 4016 | CAD Resener Spring | 无材料 |
| 4014 | CAD Resener Eccentric Stud Set Screw | 无材料 |
| 4185 | CAD Resener Eccentric Stud Set Screw | 无材料 |
| 4015 | CAD Resener Eccentric Stud Bushing | 无材料 |
| 1301 B | CAD Resener Eccentric Stud Bushing Set Screw | 无材料 |
| 4015 B | CAD Resener Stopper Set Screw | 无材料 |
| 4185 | CAD Resener Stopper Set Screw | 无材料 |
| 5-21071 | Fixed Flaw Assembly(Left) | 无材料 |
| 5-21072 | Fixed Flaw Assembly(Right) | 无材料 |
| 21073 | Fixed Flaw Bushing Spring | 无材料 |
| 21079 | Fixed Flaw Bushing Spring Pin Set Screw | 无材料 |
| 0050006 | Fixed Flaw Bushing Spring Pin Set Screw | 无材料 |
| 21077 | Fixed Flaw Bushes Shell | 无材料 |
| 0050018 | Fixed Flaw Bushes Shell Set Screw | 无材料 |
| 21079 | Fixed Flaw Bushes Shell Spring | 无材料 |
| 21077 | Fixed Flaw Bushes Shell Thrust Washer | 无材料 |
| 0050014 | Fixed Flaw Bushes Shell Thrust Washer | 无材料 |
| 21077 | Fixed Flaw Bushes Eccentric Stud Set Screw | 无材料 |
| 0050014 | Fixed Flaw Bushes Eccentric Stud Set Screw | 无材料 |
| 21080 | Fixed Flaw Bushes Eccentric Stud Set Screw | 无材料 |
| 0050016 | Fixed Flaw Bushes Eccentric Stud Set Screw | 无材料 |

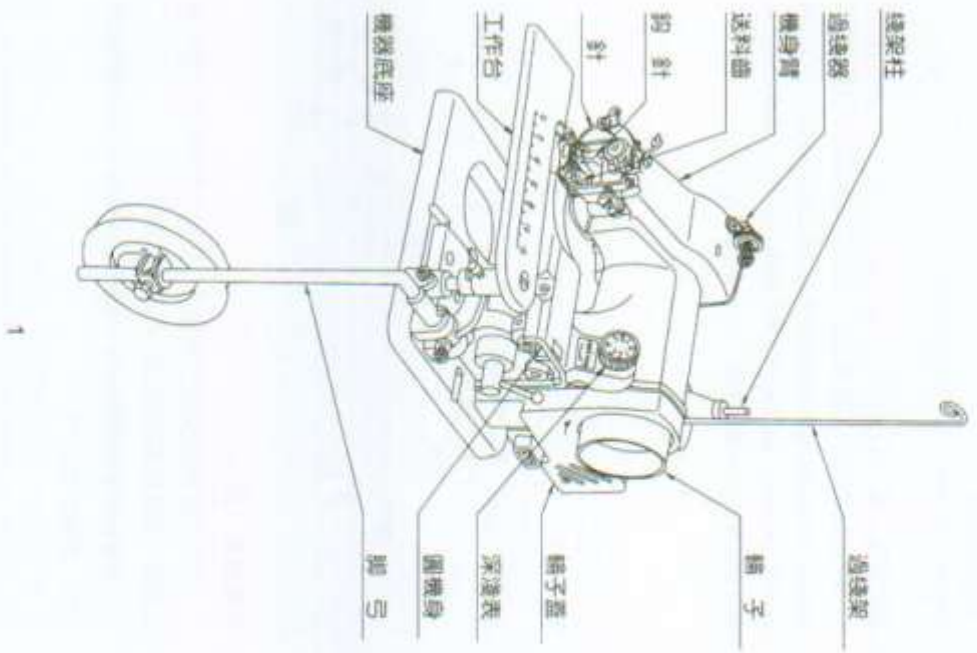

1. 機器的安裝

將機器和所有零件、附件從箱中取出。

A. 固定機器 (圖1-2)

將機器置放在一平滑桌面上。盡靠近桌面的右前方，取出附件中的螺絲鉗將機器底座栓在桌沿。螺絲鉗可從前方或右方插入底座之凹槽內。其插入的位置可依個人使用上方便來決定。但要確實將機器栓緊避免掉落。(請參考圖1及圖2)

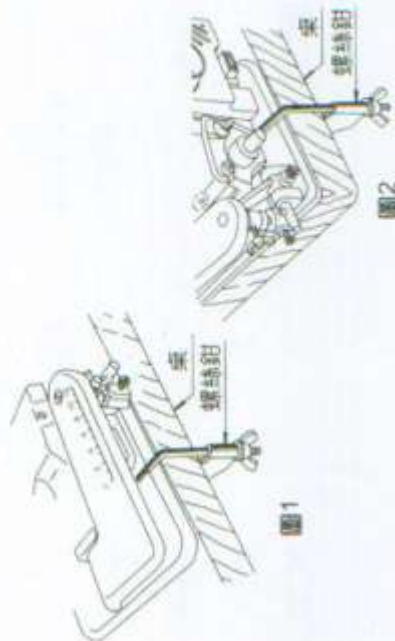

B. 安置線座 (圖3)

首先松开導線架固定栓螺絲(1)，再插入導線架(2)及固定栓(3)裝配于機器后部之穿孔內，然後拉緊螺絲(1)。接著松开導線架螺絲(4)，調整導線架頂端(5)使其朝向線架柱(6)，再拉緊螺絲(4)。

| 編號 | 零件名稱 | 零件描述 |
|-----|---------|-------|
| 1 | 螺絲鉗 | 固定螺絲鉗 |
| 2 | 21016 | 螺絲鉗 |
| 3 | 0085910 | 螺絲鉗 |
| 4 | 21016 | 螺絲鉗 |
| 5 | 21017 | 螺絲鉗 |
| 6 | 21018 | 螺絲鉗 |
| 7 | 21019 | 螺絲鉗 |
| 8 | 21020 | 螺絲鉗 |
| 9 | 21021 | 螺絲鉗 |
| 10 | 21022 | 螺絲鉗 |
| 11 | 21023 | 螺絲鉗 |
| 12 | 21024 | 螺絲鉗 |
| 13 | 21025 | 螺絲鉗 |
| 14 | 21026 | 螺絲鉗 |
| 15 | 21027 | 螺絲鉗 |
| 16 | 21028 | 螺絲鉗 |
| 17 | 21029 | 螺絲鉗 |
| 18 | 21030 | 螺絲鉗 |
| 19 | 21031 | 螺絲鉗 |
| 20 | 21032 | 螺絲鉗 |
| 21 | 21033 | 螺絲鉗 |
| 22 | 21034 | 螺絲鉗 |
| 23 | 21035 | 螺絲鉗 |
| 24 | 21036 | 螺絲鉗 |
| 25 | 21037 | 螺絲鉗 |
| 26 | 21038 | 螺絲鉗 |
| 27 | 21039 | 螺絲鉗 |
| 28 | 21040 | 螺絲鉗 |
| 29 | 21041 | 螺絲鉗 |
| 30 | 21042 | 螺絲鉗 |
| 31 | 21043 | 螺絲鉗 |
| 32 | 21044 | 螺絲鉗 |
| 33 | 21045 | 螺絲鉗 |
| 34 | 21046 | 螺絲鉗 |
| 35 | 21047 | 螺絲鉗 |
| 36 | 21048 | 螺絲鉗 |
| 37 | 21049 | 螺絲鉗 |
| 38 | 21050 | 螺絲鉗 |
| 39 | 21051 | 螺絲鉗 |
| 40 | 21052 | 螺絲鉗 |
| 41 | 21053 | 螺絲鉗 |
| 42 | 21054 | 螺絲鉗 |
| 43 | 21055 | 螺絲鉗 |
| 44 | 21056 | 螺絲鉗 |
| 45 | 21057 | 螺絲鉗 |
| 46 | 21058 | 螺絲鉗 |
| 47 | 21059 | 螺絲鉗 |
| 48 | 21060 | 螺絲鉗 |
| 49 | 21061 | 螺絲鉗 |
| 50 | 21062 | 螺絲鉗 |
| 51 | 21063 | 螺絲鉗 |
| 52 | 21064 | 螺絲鉗 |
| 53 | 21065 | 螺絲鉗 |
| 54 | 21066 | 螺絲鉗 |
| 55 | 21067 | 螺絲鉗 |
| 56 | 21068 | 螺絲鉗 |
| 57 | 21069 | 螺絲鉗 |
| 58 | 21070 | 螺絲鉗 |
| 59 | 21071 | 螺絲鉗 |
| 60 | 21072 | 螺絲鉗 |
| 61 | 21073 | 螺絲鉗 |
| 62 | 21074 | 螺絲鉗 |
| 63 | 21075 | 螺絲鉗 |
| 64 | 21076 | 螺絲鉗 |
| 65 | 21077 | 螺絲鉗 |
| 66 | 21078 | 螺絲鉗 |
| 67 | 21079 | 螺絲鉗 |
| 68 | 21080 | 螺絲鉗 |
| 69 | 21081 | 螺絲鉗 |
| 70 | 21082 | 螺絲鉗 |
| 71 | 21083 | 螺絲鉗 |
| 72 | 21084 | 螺絲鉗 |
| 73 | 21085 | 螺絲鉗 |
| 74 | 21086 | 螺絲鉗 |
| 75 | 21087 | 螺絲鉗 |
| 76 | 21088 | 螺絲鉗 |
| 77 | 21089 | 螺絲鉗 |
| 78 | 21090 | 螺絲鉗 |
| 79 | 21091 | 螺絲鉗 |
| 80 | 21092 | 螺絲鉗 |
| 81 | 21093 | 螺絲鉗 |
| 82 | 21094 | 螺絲鉗 |
| 83 | 21095 | 螺絲鉗 |
| 84 | 21096 | 螺絲鉗 |
| 85 | 21097 | 螺絲鉗 |
| 86 | 21098 | 螺絲鉗 |
| 87 | 21099 | 螺絲鉗 |
| 88 | 21100 | 螺絲鉗 |
| 89 | 21101 | 螺絲鉗 |
| 90 | 21102 | 螺絲鉗 |
| 91 | 21103 | 螺絲鉗 |
| 92 | 21104 | 螺絲鉗 |
| 93 | 21105 | 螺絲鉗 |
| 94 | 21106 | 螺絲鉗 |
| 95 | 21107 | 螺絲鉗 |
| 96 | 21108 | 螺絲鉗 |
| 97 | 21109 | 螺絲鉗 |
| 98 | 21110 | 螺絲鉗 |
| 99 | 21111 | 螺絲鉗 |
| 100 | 21112 | 螺絲鉗 |



圖3

C. 連接馬達控制器 (圖4-5)

將控制器電線的三孔插頭插入機器右方之接頭內，標準插頭則插上牆壁插座。然後放置控制器與地板上，并調整板以調整速度。

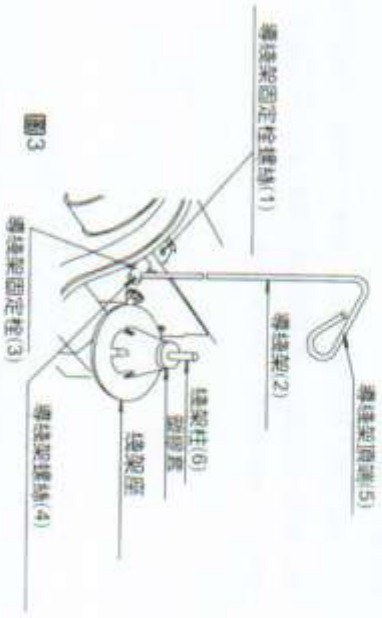
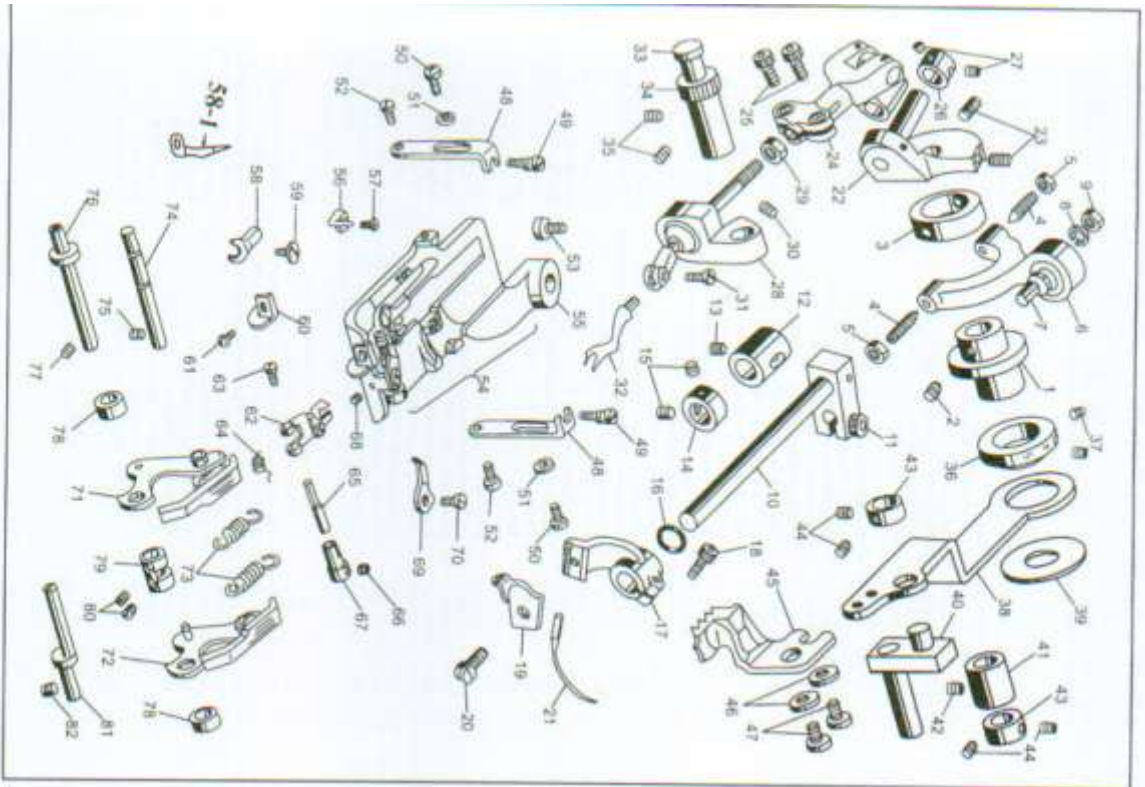

圖4



3

D. 裝配腳弓 (圖6)

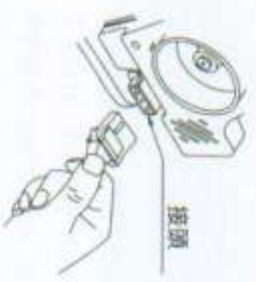
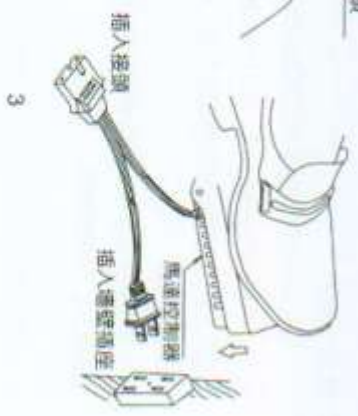
將腳弓套(1)推往腳弓軸(2)，使軸上之插銷(3)可順利進入腳弓套的L型凹槽內。若要調整腳弓角度，則鬆開螺絲(4)，調整腳弓至適當角度後，再拉緊螺絲(4)。



圖6

2. 潤滑 (圖7)

注入潤滑油對與避免操作困難與延長機器壽命相當有助益。所以如前述1裝置好機器後，即可依照圖7所指示滴少許機油于各潤滑孔內，也可開啓機器側蓋及后蓋，將機油滴在內部運轉零件上以利操作。

每次使用前或每天例行地滴一、二滴機油于圖7所指示的潤滑孔中，可保養機器。

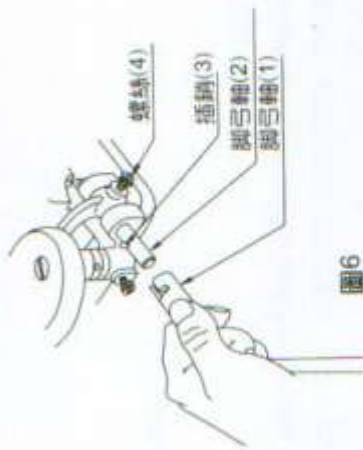
| 編號 | 零件號 | 名稱 | 描述 | 備註 |
|----|---------|---|---|--------------|
| 1 | 21012 | Main Shaft | Main Shaft | 主軸 |
| 2 | 21013 | Main Shaft Bushing (Front) | Main Shaft Bushing (Front) | 主軸前蓋襯套 |
| 3 | 0090010 | Main Shaft Holding Set Screw | Main Shaft Holding Set Screw | 主軸鎖緊螺絲(左) |
| 4 | 21014 | Main Shaft Bushing (Rear) | Main Shaft Bushing (Rear) | 主軸後蓋襯套 |
| 5 | 0090010 | Main Shaft Holding Set Screw | Main Shaft Holding Set Screw | 主軸鎖緊螺絲(右) |
| 6 | 21015 | Main Shaft Thrust Washer | Main Shaft Thrust Washer | 主軸軸承墊圈 |
| 7 | 21016 | Main Shaft Collar | Main Shaft Collar | 主軸襯套襯套 |
| 8 | 0090006 | Main Shaft Collar Set Screw | Main Shaft Collar Set Screw | 襯套鎖緊螺絲 |
| 9 | 21017 A | Pulley (Miss Green) | Pulley (Miss Green) | 滑輪(綠色) |
| 10 | 21017 B | Pulley (Wine Red) | Pulley (Wine Red) | 滑輪(酒紅色) |
| 11 | 0090014 | Pulley Set Screw | Pulley Set Screw | 滑輪鎖緊螺絲 |
| 12 | 21018 | Eccentric Bushing | Eccentric Bushing | 偏心襯套 |
| 13 | 0090008 | Eccentric Bushing Set Screw | Eccentric Bushing Set Screw | 偏心襯套鎖緊螺絲 |
| 14 | 21019 | Main Shaft Gear (Small) | Main Shaft Gear (Small) | 主軸小齒輪 |
| 15 | 0090008 | Main Shaft Gear Set Screw | Main Shaft Gear Set Screw | 小齒輪鎖緊螺絲 |
| 16 | 21020 | Skip Switch Gear (Large) | Skip Switch Gear (Large) | 跳齒大齒輪 |
| 17 | 21021 | Skip Switch Gear Eccentric Shaft Set Screw | Skip Switch Gear Eccentric Shaft Set Screw | 跳齒大齒輪偏心軸鎖緊螺絲 |
| 18 | 0090010 | Skip Switch Gear Eccentric Shaft Thrust Washer | Skip Switch Gear Eccentric Shaft Thrust Washer | 跳齒大齒輪偏心軸墊圈 |
| 19 | 21022 | Skip Switch Gear Eccentric Shaft Fork | Skip Switch Gear Eccentric Shaft Fork | 跳齒大齒輪偏心軸叉 |
| 20 | 21023 | Skip Switch Gear Eccentric Shaft Collar | Skip Switch Gear Eccentric Shaft Collar | 跳齒大齒輪偏心軸襯套 |
| 21 | 0090006 | Connecting Link (Left) | Connecting Link (Left) | 左行(左) |
| 22 | 21024 | Connecting Link (Right) | Connecting Link (Right) | 右行(右) |
| 23 | 21025 | Connecting Link Rod Holding Screw | Connecting Link Rod Holding Screw | 左行左鎖緊螺絲 |
| 24 | 0090010 | Connecting Link Rod Holding Screw Spring Ring | Connecting Link Rod Holding Screw Spring Ring | 左行左鎖緊螺絲彈簧圈 |
| 25 | 10627 | Connecting Link Rod Holding Screw Spring Washer | Connecting Link Rod Holding Screw Spring Washer | 左行左鎖緊螺絲墊圈 |
| 26 | 17202 | Connecting Rod | Connecting Rod | 連桿 |
| 27 | 21028 | Skip Switch Eccentric Shaft | Skip Switch Eccentric Shaft | 跳齒偏心軸 |
| 28 | 21029 | Skip Switch Eccentric Shaft Collar Set Screw | Skip Switch Eccentric Shaft Collar Set Screw | 跳齒偏心軸襯套鎖緊螺絲 |
| 29 | 21027 | Skip Switch Eccentric Shaft Collar | Skip Switch Eccentric Shaft Collar | 跳齒偏心軸襯套 |
| 30 | 0090006 | Skip Switch Lever Plate Set Screw | Skip Switch Lever Plate Set Screw | 跳齒撥桿鎖緊螺絲 |
| 31 | 21028 | Skip Switch Lever Plate | Skip Switch Lever Plate | 跳齒撥桿 |
| 32 | 0124004 | Skip Switch Lever Plate Ball | Skip Switch Lever Plate Ball | 跳齒撥桿球 |
| 33 | 4010 | Skip Switch Lever Plate Spring | Skip Switch Lever Plate Spring | 跳齒撥桿彈簧 |
| 34 | 10622 | Skip Switch Lever Set Screw | Skip Switch Lever Set Screw | 跳齒撥桿鎖緊螺絲 |
| 35 | 6-21029 | Skip Switch Lever Set Screw | Skip Switch Lever Set Screw | 跳齒撥桿鎖緊螺絲 |
| 36 | 0090010 | Connecting Link (Short) | Connecting Link (Short) | 短連桿 |
| 37 | 21031 | Connecting Link Holding Pin | Connecting Link Holding Pin | 連桿鎖緊銷 |
| 38 | 21032 | Connecting Link Holding Pin Snap Ring | Connecting Link Holding Pin Snap Ring | 連桿鎖緊銷彈簧圈 |
| 39 | 10600 | Connecting Link Holding Pin Set Screw | Connecting Link Holding Pin Set Screw | 連桿鎖緊銷鎖緊螺絲 |
| 40 | 0090004 | Connecting Block | Connecting Block | 連桿鎖緊螺絲鎖緊螺絲 |
| 41 | 21033 | Ridge Forming Disc Shaft Assembly | Ridge Forming Disc Shaft Assembly | 成型盤鎖緊螺絲鎖緊螺絲 |
| 42 | 0214012 | Ridge Forming Disc Shaft Collar | Ridge Forming Disc Shaft Collar | 成型盤鎖緊螺絲鎖緊螺絲 |
| 43 | 5-21034 | Ridge Forming Disc Shaft Collar Set Screw | Ridge Forming Disc Shaft Collar Set Screw | 成型盤鎖緊螺絲鎖緊螺絲 |
| 44 | 21036 | Ridge Forming Disc Shaft Building | Ridge Forming Disc Shaft Building | 成型盤鎖緊螺絲鎖緊螺絲 |
| 45 | 0090004 | Ridge Forming Disc Shaft Building Set Screw | Ridge Forming Disc Shaft Building Set Screw | 成型盤鎖緊螺絲鎖緊螺絲 |
| 46 | 10117 | Cylinder Rod Shaft | Cylinder Rod Shaft | 圓柱桿 |
| 47 | 0090006 | Cylinder Rod Shaft Holding Set Screw | Cylinder Rod Shaft Holding Set Screw | 圓柱桿鎖緊螺絲 |
| 48 | 21040 | Cylinder Rod Shaft Set Screw | Cylinder Rod Shaft Set Screw | 圓柱桿鎖緊螺絲 |
| 49 | 0090006 | Cylinder Rod Shaft Spring Ring | Cylinder Rod Shaft Spring Ring | 圓柱桿鎖緊螺絲彈簧圈 |
| 50 | 10117 | Cylinder Rod Shaft Spring Pin | Cylinder Rod Shaft Spring Pin | 圓柱桿鎖緊螺絲彈簧銷 |
| 51 | 21070 | Cylinder Rod Shaft Spring Pin | Cylinder Rod Shaft Spring Pin | 圓柱桿鎖緊螺絲彈簧銷 |
| 52 | 21071 A | Cylinder Rod Shaft Collar | Cylinder Rod Shaft Collar | 圓柱桿鎖緊螺絲鎖緊螺絲 |
| 53 | 21016 | Cylinder Rod Shaft Collar Set Screw | Cylinder Rod Shaft Collar Set Screw | 圓柱桿鎖緊螺絲鎖緊螺絲 |
| 54 | 0090006 | Cylinder Rod Shaft Collar Set Screw | Cylinder Rod Shaft Collar Set Screw | 圓柱桿鎖緊螺絲鎖緊螺絲 |



圖 7

3. 針與線

應使用 LW x 6T 的針

為確保操作滿意度，線和縫制物必須搭配如下表示：

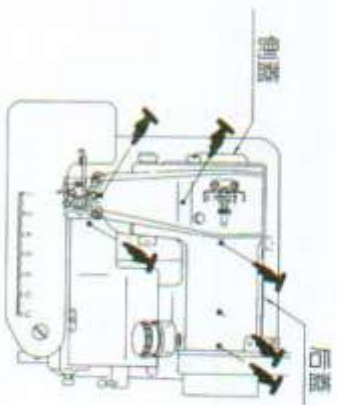
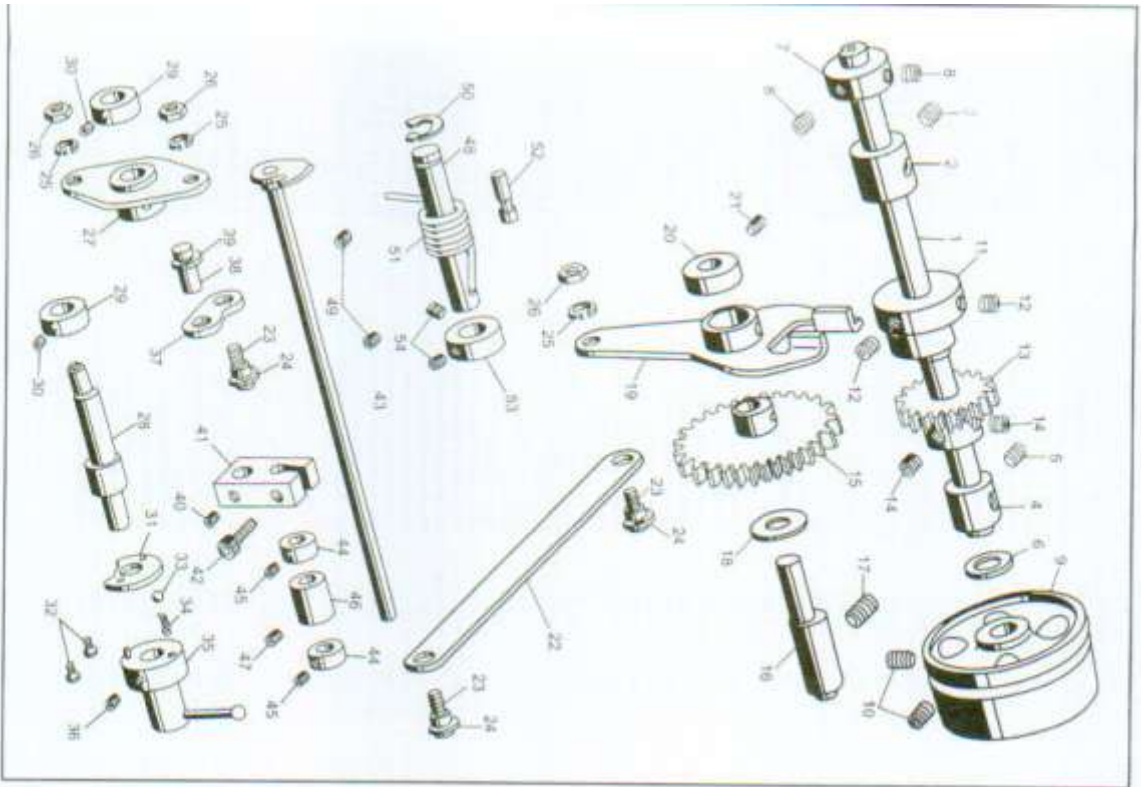
| 針 | 線 | 材 質 |
|----------------|-------------|------------|
| SIZE 3(11) | NO.80 - 100 | 尼龍線或其他薄物料 |
| SIZE 3 1/2(14) | NO.60 - 70 | 棉、羊毛或其他中粗料 |
| SIZE 4(16) | NO.50 - 60 | 厚羊毛或其他厚物料 |

4. 換針 (圖8)

以手動旋轉轆子 (依順時鐘方向) 直到針到達最高點位置, 再鬆開鎖針螺絲(1)約兩圈后將針取下接著將新針插入針柱(2)中并將它推到頂端, 然后套上鎖針片并拉緊鎖針螺絲即完成。
(請參考圖8針柱與相關零件之分解圖)



圖8

5. 上線 (圖9-12)

A. 使用車縫線時, 將車縫線置于綫座塑膠套上。(圖9)

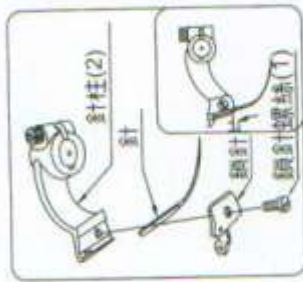

圖9

| 備用零件號 Ref. Num. | 零件號 Parts No. | 名稱 Description | 名稱 |
|--------------------|------------------|---|------------------|
| 1 | 21001 | Machinist Pin | 針 |
| 2 | 21002 | Cylinder Rod | 汽機柱 |
| 3 | 21003 | Arm Side Cover | 汽機側蓋 |
| 4 | 21004 | Arm Side Cover Clamp Screw | 汽機側蓋夾緊螺絲 |
| 5 | 21005 | Pin | 螺絲 |
| 6 | 0144016 | Pin | 螺絲 |
| 7 | 21006 | Arm Rear Cover | 汽機後蓋 |
| 8 | 0144009 | Arm Rear Cover Set Screw | 汽機後蓋夾緊螺絲 |
| 9 | 21007 | Pin | 螺絲 |
| 10 | 0173005 | Pin | 螺絲 |
| 11 | S-21008-G | Machine Base with Rubber Cushion (Miss-Green) | 汽機底座 (綠) |
| 12 | S-21008-R | Machine Base with Rubber Cushion (White-Roll) | 汽機底座 (白) |
| 13 | 21009 | Rubber Cushion A | 橡皮墊 (A) |
| 14 | 0160016 | Rubber Cushion B | 橡皮墊 (B) |
| 15 | 0160016 | Machinist Base Clamp Screw | 汽機底座夾緊螺絲 |
| 16 | 01009-A | Motor | 馬達 |
| 17 | B-005 | Motor Bracket Set Screw | 汽機馬達夾緊螺絲 |
| 18 | B-006 | Motor Bracket Spring Washer | 汽機馬達彈簧墊圈 |
| 19 | B-007 | Motor Bracket Spring Washer | 汽機馬達彈簧墊圈 |
| 20 | 21160 | Motor Belt | 汽機皮帶 |
| 21 | 01511 | Needle System Label (1/8x017) | 針架零件清單 (1/8x017) |
| 22 | 4135 | Thread Guide (Pig Tail) | 之風線 |
| 23 | 0144008 | Thread Guide Set Screw | 之風線夾緊螺絲 |
| 24 | S-21009 | Thread Tension Assembly (Ref. Nos. 24-29) | 高拉緊度零件 (參照24-29) |
| 25 | 21009 | Thread Tension Bracket | 高拉緊度螺絲架 |
| 26 | 21009 | Thread Tension Post | 高拉緊度螺絲柱 |
| 27 | 4070 | Thread Tension Post Nut | 高拉緊度螺絲帽 |
| 28 | 9199-A | Thread Tension Disc | 高拉緊度螺絲盤 |
| 29 | 79-3 | Thread Tension Spring | 高拉緊度螺絲彈簧 |
| 30 | 83 | Thread Tension Nut | 高拉緊度螺絲帽 |
| 31 | 0144008 | Thread Tension Bracket Set Screw | 高拉緊度螺絲架夾緊螺絲 |
| 32 | 0046006 | Thread Guide Stud Set Screw | 高拉緊度螺絲架夾緊螺絲 |
| 33 | 21004 | Thread Stand | 螺絲架 |
| 34 | AC-101 | Thread Stand Base | 螺絲架底座 |
| 35 | 11145 | Photo's Cup | 照相杯 |
| 36 | 10543 | Thread Stand Nut | 螺絲架帽 |
| 37 | S-10513-G | Disc Regulator (Miss-Green) | 高拉緊度零件 (綠) |
| 38 | S-10513-R | Disc Regulator (White-Roll) | 高拉緊度零件 (白) |
| 39 | 4074 | Disc Regulator Set Screw | 高拉緊度零件夾緊螺絲 |
| 40 | 10514 | Disc Regulating Dial Screw | 高拉緊度零件夾緊螺絲 |
| 41 | 10516 | Disc Regulating Dial Screw Plug | 高拉緊度零件夾緊螺絲塞 |
| 42 | 10515-A | Disc Regulating Photo Spring Set Screw | 高拉緊度零件夾緊螺絲 |
| 43 | 8339 | Disc Regulating Photo Spring Label | 高拉緊度零件夾緊螺絲標籤 |
| 44 | 21004 | Stop Switch Label | 螺絲架底座 |
| 45 | 21012 | Cylinder Bell Connecting Hook | 螺絲架底座 |
| 46 | 10076-A | Cylinder Bell Connecting Hook Screw | 螺絲架底座 |
| 47 | 21005 | Knur Lifter Crank | 螺絲架底座 |
| 48 | 21003 | Knur Lifter Crank Set Screw | 螺絲架底座 |
| 49 | 21004 | Knur Lifter Shaft | 螺絲架底座 |
| 50 | 10074 | Knur Lifter Shaft Spring Pin | 螺絲架底座 |
| 51 | 21002 | Work Plate Bracket | 螺絲架底座 |
| 52 | 0210016 | Work Plate Bracket Set Screw | 螺絲架底座 |
| 53 | 21001 | Work Plate | 螺絲架底座 |
| 54 | 10065 | Work Plate Wing Screw | 螺絲架底座 |
| 55 | 10002 | Work Plate Shaft | 螺絲架底座 |
| 56 | 0210012 | Work Plate Shaft Set Screw | 螺絲架底座 |
| 57 | 21023 | Work Plate Shaft Collar | 螺絲架底座 |
| 58 | 0099006 | Work Plate Shaft Collar Set Screw | 螺絲架底座 |
| 59 | 10063 | Work Plate Screwed Cap | 螺絲架底座 |

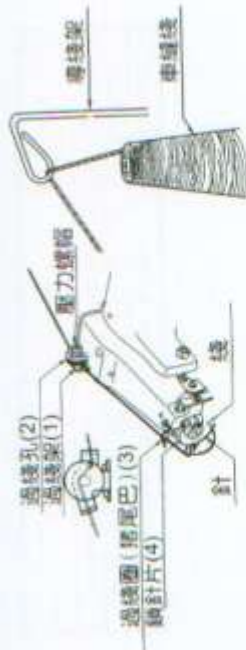
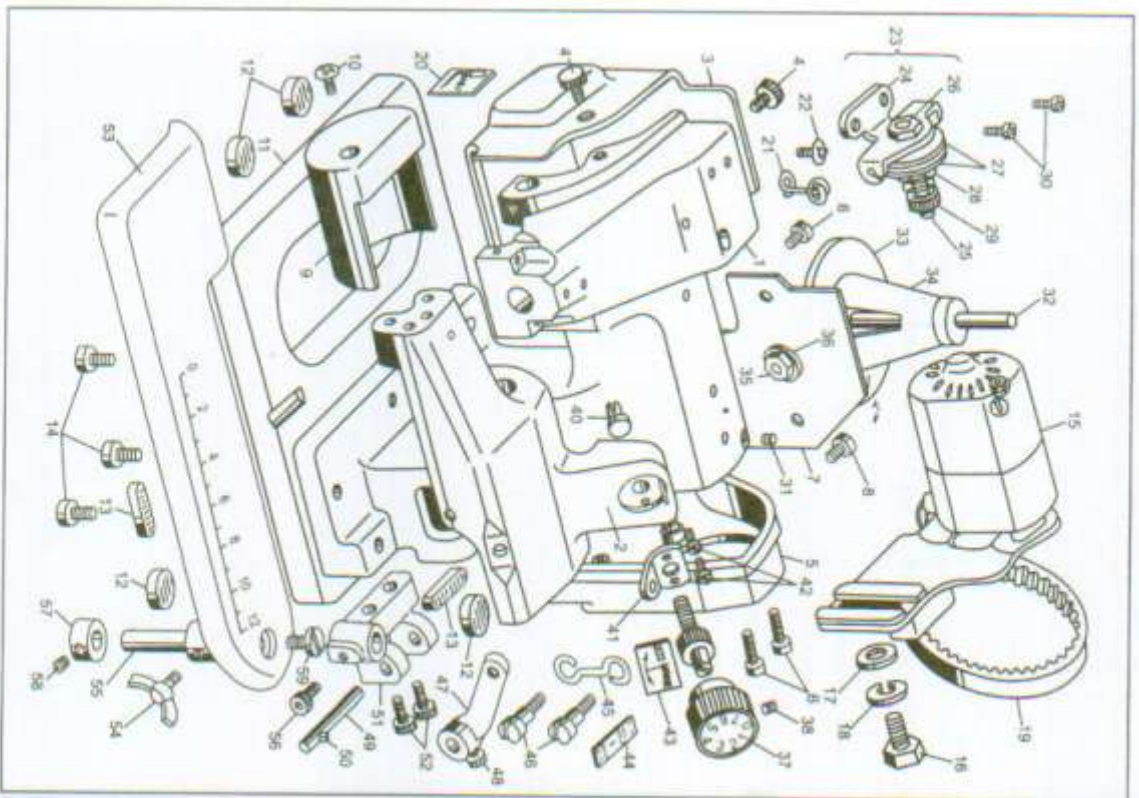

B. 使用一般縫紉時，取下塑膠蓋
將縫紉裝置在縫架柱上。

(圖10)

C. 正確的裝紉方法，請仔細參照
圖9所示。



圖10

當達到通過縫器 (1) 時，將線由后孔 (2) 穿入并導引其由前孔穿出 (如圖9)，再牽線至前方由上往下穿過過線圈 (3) 和頂針片的縫孔 (4)。此時要注意針的方向必須是偏左方，再將線由下方穿過針孔后拉出即完成 (如圖11)。

若鬆開工作台螺絲將工作台拉開，則縫穿過針孔會更容易。(圖12)

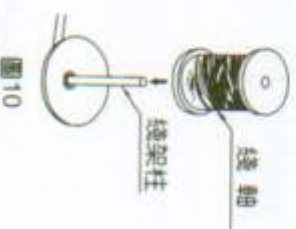

圖11



圖12

6. 縫制的準備 (圖 13~14)

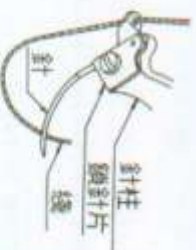
壓下腳弓，使圓機身向下擺并形成押腳與圓機身間的縫隙。
再將縫制物折疊平放置入針板押舌縫隙內，或讓物料的縫邊和
靠邊的邊緣成平行。

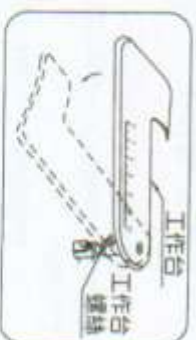

圖 13



圖 14-1

圖 14-2

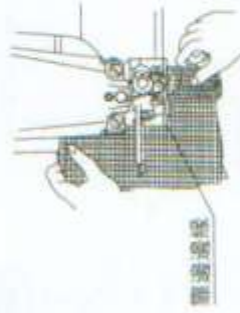
當物料放妥后即松开腳弓，緩緩開始操作機器，勿只將視
線集中在針的動作上，而應該注意使物料能確實沿靠邊邊緣平
行移動。

- A. 雙層縫邊時，將物料置放如圖 14-1 所示
- B. 單層縫邊時，將物料置放如圖 14-2 所示

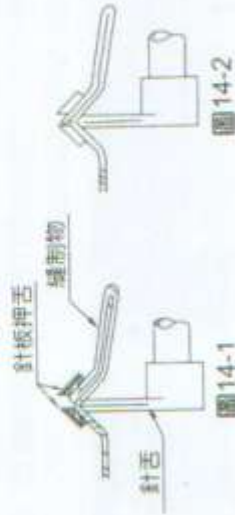
PARTS LIST

8. 設定縫目距離 (圖 17)

松轉側蓋上的兩個螺絲并開啓側蓋后，再松轉位于縫目調節圖(2)上的兩個螺絲(1)；接著轉動調節圖(2)直到V型溝(3)對准欲設定之數字，最后旋緊螺絲(1)即可。

機器自本公司出廠時均預設縫目距離于“6”的位置上。



圖 17

調節圖上的數字所代表之縫目距離如下表所示：

| 調節圖數字 | 4 | 5 | 6 | 7 | 8 |
|-----------|---|---|---|---|---|
| 縫目距離 (MM) | 4 | 5 | 6 | 7 | 8 |

為選擇最適當縫目，建議使用不同材質前先行試車。

9. 調整下針深淺 (圖 18)

下針的深度可以藉由旋轉機器前方的深淺表來調節。



圖 18

車薄物時欲增加下針的深度，須將深淺表逆時鐘方向旋轉，深淺表上所指示的數字愈大表示下針愈深；反之，車薄物時欲減低深度，則將深淺表朝順時鐘方向旋轉。為防止損壞針和機器，建議開始車縫時以淺針車一小段縫邊，再視車縫狀況決定所選用的深淺度。

注意：調整深淺表必須于機器靜止的狀態下方可行，切勿于機器運轉時調整。

10. 取出縫制物 (圖 19)

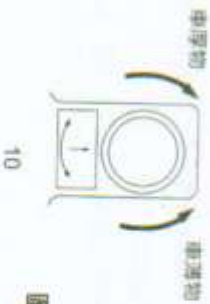
先停止車縫動作，依順時鐘方向轉動輪子直到針完全脫離縫制物（針到達最高點），接著往右壓下腳弓并將縫制物從機器后方迅速地拉出，此動作可鎖住尾邊的縫頭并折斷縫線。



圖 19

11. 跳縫裝置 (圖20~21)

機器右側的調整杆是控制跳縫的裝置。當此杆扳向“NO SKIP”位置時，為一般縫法，每一縫目穿透物料一次；若扳向“SKIP”位置時，為跳縫法，每隔一縫目穿透物料一次。

為確保操作理想，此調整杆必須設定在其中一方直到車縫終止。若調整杆扳向中央將無法掌握縫品質，此外還應注意每回由“SKIP”改設定為“NO SKIP”時，因視需要重新調整深淺表。

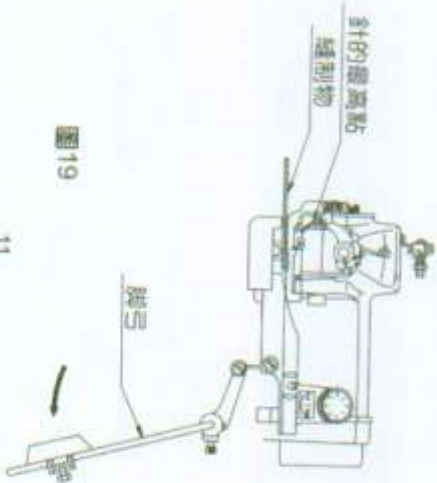

圖20



圖21

7. 調整綫壓 (圖 15~16)

不同材質的布料和縫綫需要配合不同的綫壓。綫壓可藉由轉動機身背上方的壓力螺帽來調整。

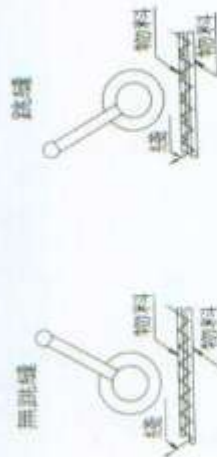

圖 16



圖 15

欲增強綫壓，將螺帽依順時鐘方向轉動；欲減弱綫壓，則將螺帽依逆時鐘方向轉動。

每次轉松或轉緊皆避免轉動超過1/4圈，必要時可先測試結果再重新調整。